

WIEHAG GLULAM

The high-tech,
low carbon solution
for multi-storey
structures

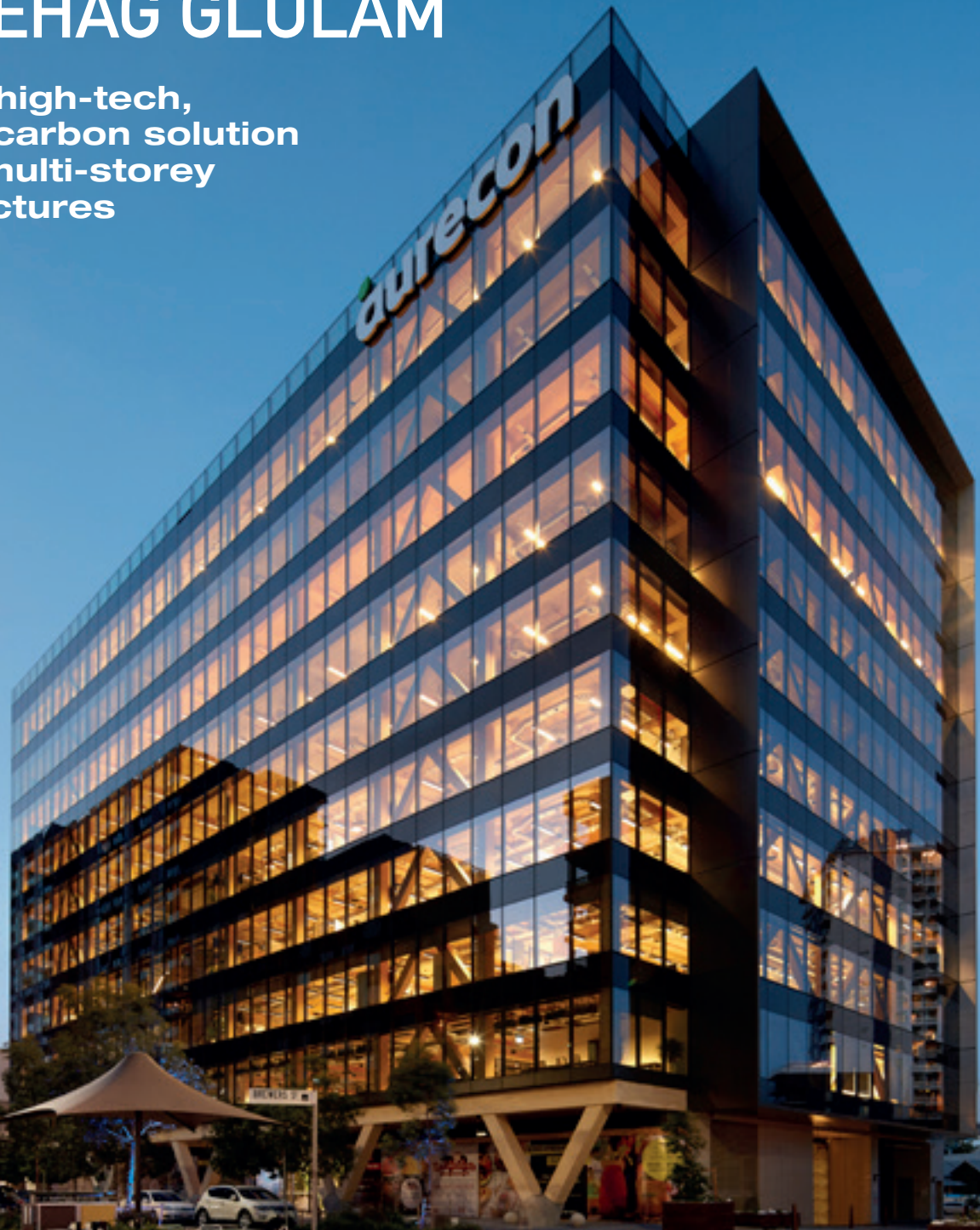

25 King Street, Brisbane



25 KING STREET, BRISBANE

The market share for multi-storey buildings made of glulam timber & cross laminated timber (CLT) is growing steadily. WIEHAG offers timber specialists around the globe a complete Glulam kit that's ready to install.

- As the local timber specialist, the design would be by yourselves, with the shop drawings prepared by WIEHAG's in-house design office, and based on your Cadwork or IFC file.
- Production of the fully machined glulam kit is carried out by WIEHAG at their high tech factory in Austria using advanced CNC machinery.
- Custommade or standard galvanised steel connectors are preassembled with the glulam elements at WIEHAG's factory in order to ensure fast and safe installation to industry leading standards of quality and finish.
- The finished product is packaged and carefully loaded onto containers and shipped to your site, ready for you to unload and install.
- The CLT package to form the floors, roofs and walls would be by others, and WIEHAG can recommend suitable suppliers if required.
- Whilst WIEHAG can also offer design and installation in collaboration with you as the local timber specialist, we see distinct advantages if we act only the 'workbench', and you take care of the rest, as this enables the package to achieve cost leadership compared to a single design, supply & install package.



THE IMPORT BUILDING, LONDON

GLULAM FOR MULTI-STOREY BUILDINGS

Timber frames are four times lighter than their equivalent in concrete so foundations are reduced. Offsite solutions offer fast, safe assembly with significantly fewer defects and increased quality. And sustainability is already built in, with the average project capturing hundreds of tonnes of CO². Fire resistance can be achieved simply by oversizing components and embedding connectors within the timber. Less waste, dust and noise on site, plus reduced vehicle journeys mean disruption to neighbours is minimised. Glulam offers an attractive appearance without the need for expensive claddings. Low maintenance throughout the buildings design life if properly detailed.



OVER 170 YEARS OF EXPERIENCE...

Building on our experience and expertise we show imagination and foresight, while never neglecting economic efficiency and required functionality.



CROSSRAIL STATION, LONDON

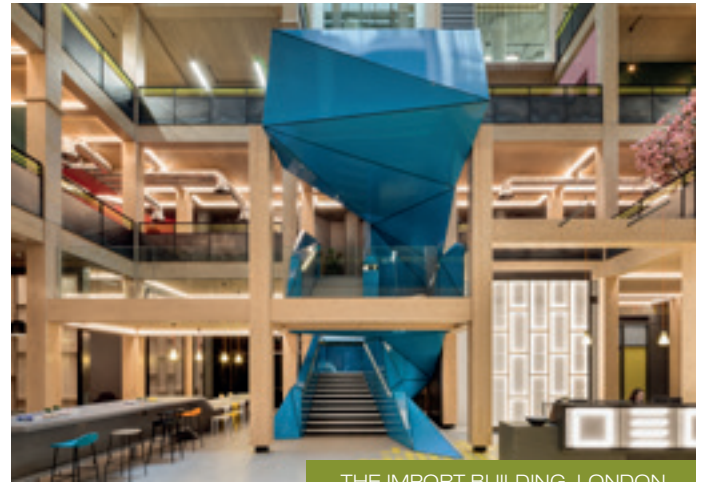

THE IMPORT BUILDING, LONDON



WAREHOUSE LÜBECK



THE MACALLAN DISTILLERY

PRODUCT AND PRODUCTION

- High quality off-site solutions using advanced CNC machined glulam parts
- Tailor-made solutions for every project
- Factory fitted steel connectors
- Worldwide deliveries including logistics planning & just-in-time delivery
- Wide range of specifications available for different wood species, coatings etc.
- WIEHAG can provide samples and mock-ups if required, as well as technical assistance.





CNC TECHNOLOGY

WIEHAG's glulam offer is aimed at major projects around the world; no project is too big for our state-of-the-art factory, with its capacity to produce thousands of m³ of high-quality glulam products, using cutting edge CNC technology, expertly managed by our highly trained workforce.

LOGISTICS

WIEHAG transports and ships worldwide to your site in containers or as bulk load. Detailed 3D logistics planning ensures that materials arrive on time and in the right order for your installation. All elements are wrapped for delivery in accordance with ISPM15, and placed on sleds for easy unloading from containers.



CONTAINER LOADING



All waste timber is fed into WIEHAG's brand new bio-mass power station, which enables our entire operation to be energy autarkic, as well as saving over 7,100 Tonnes of CO² annually.



SUSTAINABILITY

WIEHAG procures 100% of its sawn timber from sustainably managed, mainly Austrian forests, and uses the PEFC & FSC chain of custody schemes to demonstrate our commitment to only using sustainable timber.

Once timber was seen as old-fashioned compared to steel and concrete, but major advances in design and manufacturing technology have enabled solid timber products like glulam to become a leading, renewable, low-carbon solution.





Timber construction is, without any doubt, one way to achieve a sustainable future for all. We can seize this opportunity together. WIEHAG is the right partner for you in this endeavour.”

Dr. Erich Wiesner
CEO WIEHAG

WIEHAG is a family owned company founded in 1849, with glulam production commencing in 1953, and WIEHAG's first 100m clear span landmark project successfully completed in 1966.

The company is run by the fifth generation of the Wiesner family, who continue to inspire and steer the company to face the challenges and opportunities of the 21st century.



WIEHAG GmbH | AUSTRIA

Linzer Straße 24
4950 Altheim
T. +43 (0) 7723 465 0
enquiry@wiegag.com

WIEHAG UK Ltd | UNITED KINGDOM

4th Floor, 104-110 Goswell Road,
London EC1V 7DH
T. +44 (0) 20 7490 8857
j.spittle@ukrep.wiegag.com

WIEHAG GmbH | SPAIN

C/Larrauri, 1-A, 3º. Dpto 8
48160 Derio, Vizcaya
T. +34 (0) 649 324 038
p.cearra@wiegag.com

To discover all projects & references go to www.wiegag.com

